

## 3. SPOJNI PRIBOR General hardware

### 3.5. Natezni vijci, zateznice

#### Natezni vijak DIN 1480 RX-lift

Turnbuckle acc. to DIN 1480 RX-lift

2.1 2.2

Promjer navoja A (mm)	B (mm)	C (mm)	D (mm)	E (mm)	F (mm)	G (mm)	H (mm)	I (mm)	J (mm)	K (mm)	Težina (kg/kom)
5	125	180	70	56	57	35	7	12	16	8	0,07
6	172	258	110	77	80	55	8	15	20	9	0,11
8	184	264	110	85	84	57	10,5	15	22	10	0,2
10	222	311	125	106	105	68	13	11	31	14	0,28
12	241	324	125	117	111	70	16	13	35	16	0,43
14	261	351	140	124	122	75	18	15	40	18	0,61
16	311	427	170	144	150	88	20	17	47	22	1
20	358	490	200	170	167	105	21	21	52	24	1,6
22	414	559	220	200	186	118	24	28	60	27	2,2
24	453	630	255	215	205	135	26	33	65	27	2,8
30	495	660	255	240	220	135	34	35	71	31	4,1
33	545	744	295	260	245	148	38	40	88	36	6
36	597	782	295	275	277	158	46	45	94	38	8,5

- kombinacije završetaka: kuka-kuka, oko-oko, kuka-oko
- materijal: nelegirani čelik
- završna obrada: cinčano ili vruće galv.

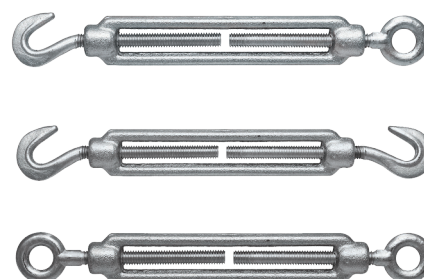
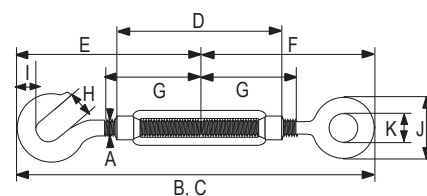

#### Tijelo nateznog vijka DIN 1480 RX-lift

Turnbuckle frame acc. to DIN 1480 RX-lift

2.1 2.2

D1 (mm)	D2 (mm)	E (mm)	F (mm)	H (mm)	L (mm)	M1 (mm)	M2 (mm)
M 6	12	19	9	6	110	12	6
M 8	15	23	11	8	110	15	8
M 10	18	30	14	9	125	18	9
M 12	21	34	16	11	125	21	11
M 14	25	38	18	10	140	24	9
M 16	27	42	20	14	170	27	14
M 20	34	52	24	17	200	34	17
M 22	36	57	26	16	220	37	15
M 24	39	60	28	20	255	39	20
M 30	45	74	34	23	255	45	23
M 36	55	86	40	28	295	55	28
M 42	63	104	50	32	330	63	32

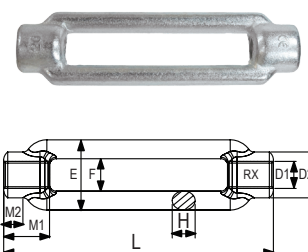

- materijal: nelegirani čelik
- završna obrada: cinčano ili vruće galv.