

2. PRIBOR G80 I G100 G80 and G100 accessories

2.1. Pribor G80

Okretni vijak sa ležajem G80 RX173

Lifting pivoting point G80

2.1 2.2 CE

Navoj	Nosivost na 0° (t)	Prekidna sila (t)	A (mm)	B (mm)	C (mm)	D (mm)	E (mm)	M (mm)	L (mm)	L' (mm)	φ (mm)	Težina (kg/kom)
Thread	WLL 0°	BL										Weight
M8	0.3	1.2	35	52.5	6	30	13	45	46	10.4	14	0.36
M8x76	0.3	1.2	35	52.5	6	30	13	45	46	76	14	0.39
M10	0.63	2.52	35	52.5	6	30	17	45	52	16	14	0.38
M10x96	0.63	2.52	35	52.5	6	30	17	45	52	96	14	0.43
M12	1	4	40	54	8	36	19	68	62	18	18	0.71
M12x114	1	4	40	54	8	36	19	68	158	114	18	0.8
M14	1.2	4.8	40	54	8	36	19	68	66	21	18	0.72
M14x140	1.2	4.8	40	54	10	36	22	68	185	140	18	0.86
M16	1.5	6	40	54	8	36	19	68	70	24	18	0.74
M16x30	1.5	6	40	54	8	36	19	68	70	30	18	0.74
M16x40	1.5	6	40	54	8	36	19	68	70	40	18	0.75
M16x100	1.5	6	40	54	10	36	24	68	146	100	18	0.85
M16x149	1.5	6	40	54	10	36	24	68	195	149	18	0.92
M16x194	1.5	6	40	54	10	36	24	68	240	194	18	0.99
M18x26	2	8	54	80	12	50	30	83	83	26	16	1.16
M18x180	2	8	54	80	12	50	30	83	237	180	16	1.47
M20	2.5	10	54	80	12	50	30	83	88	30	16	1.19
M20x55	2.5	10	54	80	12	50	30	83	113	55	16	1.21
M20x60	2.5	10	54	80	12	50	30	83	118	60	16	1.25
M20x100	2.5	10	54	80	12	50	30	83	156	100	16	1.57
M20x187	2.5	10	54	80	12	50	30	83	118	187	16	2.27
M24x35	4	16	54	94	14	50	36	83	95	35	18	1.35
M24x40	4	16	54	94	14	50	36	83	100	40	18	1.38
M24x60	4	16	54	94	14	50	36	83	120	60	18	1.46
M24x80	4	16	54	94	14	50	36	83	138	80	18	1.54
M24x100	4	16	54	94	14	50	36	83	158	100	18	1.62
M24x222	4	16	54	94	14	50	36	83	120	222	18	2.11
M27	4	16	73	106	17	68	41	120	120	38	27	4.18
M27x270	4	16	73	106	17	68	41	120	352	270	27	5.22
M30	5	20	73	106	17	68	41	120	132	48	27	4.4
M30x70	5	20	73	106	17	68	41	120	154	70	27	4.19
M30x279	5	20	73	106	17	68	41	120	154	279	27	5.35
M36x54	7	28	73	106	17	68	41	120	142	54	27	4.65
M36x62	8	32	94	140.5	22	86	55	156	163	62	31	7.6
M36x70	7	28	73	106	17	68	41	120	158	70	27	4.8
M36x223	8	32	94	140.5	22	86	55	156	324	223	31	8.94
M42	10	40	94	140.5	24	86	65	156	176	72	31	8.2
M42x63	15	60	104	155	24	95	65	176	179	63	40	12.4
M42x263	15	60	104	155	24	95	65	176	379	263	40	14.6
M48x74	20	80	104	155	24	95	75	176	194	74	40	13
M48x295	20	80	104	155	24	95	75	176	194	295	40	16.1

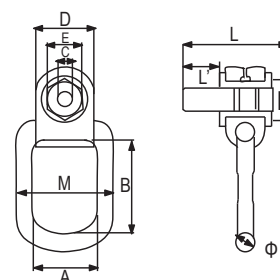

• EN1677-1

