

2. PRIBOR G80 | G100 G80 and G100 accessories

2.1. Pribor G80

Skračivač lanca-kuka G80 RX085

Eye shortening cradle grab hook G80

2.1 2.2 CE BL

Promjer lanca (mm)	Nosivost (t)	Min. prekidna sila (t)	E (mm)	D (mm)	H (mm)	R (mm)	L (mm)	Težina (kg/kom)
Chain dia.	WLL	MBL						Weight
6-8	1.12	4.48	8	13.5	17.9	51.4	75.3	0.14
7/8-8	2	8	10.8	18	20	61.5	91.2	0.245
10-8	3.15	12.6	13	20	29	80	122	0.65
13-8	5.3	21.2	16.5	26	42.8	99.7	158	1.39
16-8	8	32	20	30.5	47.7	104	169	2.2
18/20-8	12.5	50	25	37.5	56	140	219	4.6
22-8	15	60	28	44	68	165	259	8.2
26-8	21.2	84.8	30	41	77	188.5	298	9.8
32-8	31.5	126	38	57	95	228	361	19.4

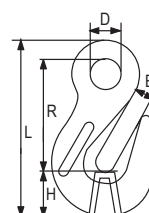

• EN 1677-1

Skračivač lanca-kuka G80 RX086

Clevis shortening grab hook G80

2.1 2.2 CE BL

Promjer lanca (mm)	Nosivost (t)	Min. prekidna sila (t)	E (mm)	A (mm)	H (mm)	W (mm)	L (mm)	Težina (kg/kom)
Chain dia.	WLL	MBL						Weight
6-8	1.12	4.48	8	8	16	26.7	75	0.25
7/8-8	2	8	10.8	9.5	21.6	33.5	90	0.32
10-8	3.15	12.6	13.5	12.5	30	46	126	0.73
13-8	5.3	21.2	16.5	15	42.5	57.5	163.5	1.6
16-8	8	32	19.2	19.5	45.5	74	183.5	2.8
18/20-8	12.5	50	24	24	56	74	219	5
22-8	15	60	27	27	68.5	90	254	6.3
26-8	21.2	84.8	30	30	77	102	309	14.5

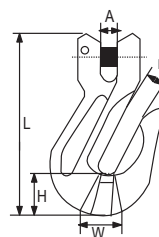

• EN 1677-1

Skračivač lanca G80 RX073

Clevis shortening clutch G80

2.1 2.2 CE BL

Promjer lanca (mm)	Nosivost (t)	Min. prekidna sila (t)	P (mm)	C (mm)	A (mm)	B (mm)	H (mm)	S (mm)	L (mm)	D (mm)	Težina (kg/kom)
Chain dia.	WLL	MBL									Weight
6-8	1.12	4.48	7.5	7.5	8	44	10.3	12	73.5	7.8	0.17
7/8-8	2	8.0	9.5	9.5	10.5	61.7	14	17	101	9.2	0.37
10-8	3.15	12.6	13	13	12.4	92	18.4	28	138	13.2	0.97
13-8	5.3	21.2	16.5	16.5	16	115	22.7	34.5	177	16.2	2.01
16-8	8	32	21	21	19.5	143	28.5	40	220	20	3.32
18/20-8	12.5	50	23.5	23.5	23	152	33.6	46	238	24.3	6.2
22-8	15	60	25.5	25.5	26	195	39	57.5	295	28.1	8.5

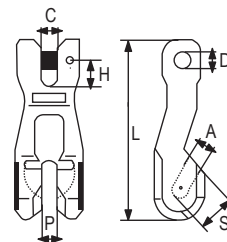

• EN 1677-1

Skračivač za lanac sa osiguračem G80 RX638

Clevis shortening clutch with safety pin G80

2.1 2.2 CE BL

Promjer lanca (mm)	Nosivost (t)	Min. prekidna sila (t)	A (mm)	B (mm)	C (mm)	D (mm)	P (mm)	L (mm)	Težina (kg/kom)
Chain dia.	WLL	MBL							Weight
7/8-8	2	8	50	9.5	33	9.5	9.2	92	0.41
10-8	3.15	12.6	60	12.5	43	12.5	13.3	115	0.75
13-8	5.3	21.2	79	15	55	15	16.3	149	1.67

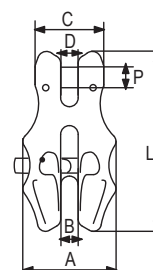

• EN 1677-1

www.remex.hr 51